

# ELOÉ™

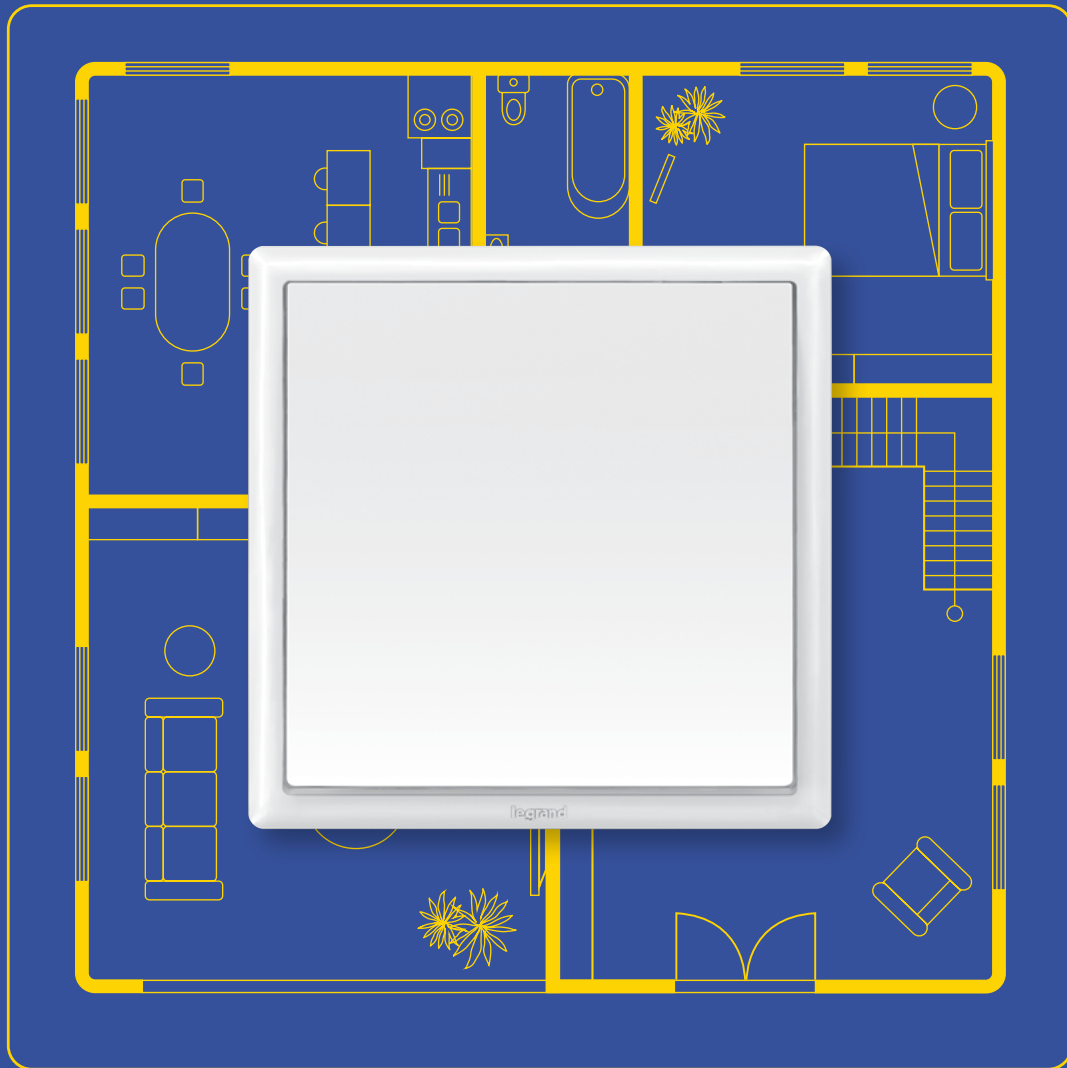

Everything just **ADDS** up

THE GLOBAL SPECIALIST  
IN ELECTRICAL AND DIGITAL BUILDING INFRASTRUCTURES

 **legrand**®

# ELOÉ™

When you choose **ELOÉ™** for your project, you are not just choosing a modern design and versatile functions, you are also opting for easy installation – and better value. **ELOÉ™** adds to your winning formula.

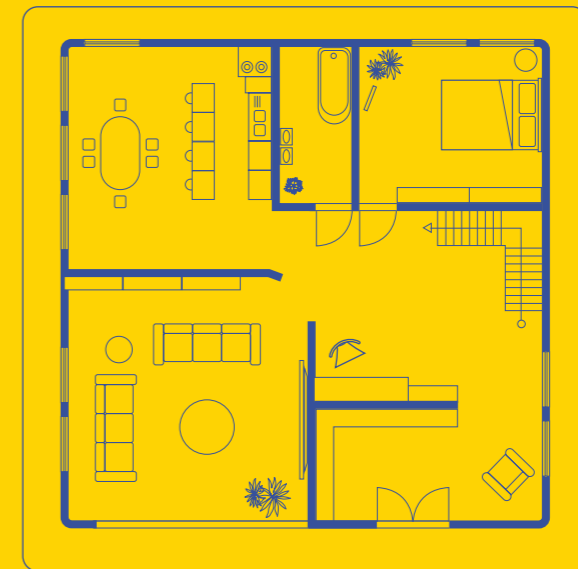

Everything just  
**ADDS** up

## CONTENTS

- 02 **ADD DETAILS** that matter
- 04 **ADD VALUE** to your productivity
- 06 **ADD POSSIBILITIES** to projects
- 08 **ADD** a touch of **COMFORT**
- 10 Catalogue pages

# ADD DETAILS that matter

Good design doesn't always have to be complex. With **ELOÉ™**, it combines details that make sense and add to the overall experience – for both users and installers.



**SUBTLE CURVES**  
Rounded corners and curves add a touch of elegance.



**STRONG PROFILE**  
Clean lines and a distinct shape enhance the visual appeal of **ELOÉ™**.

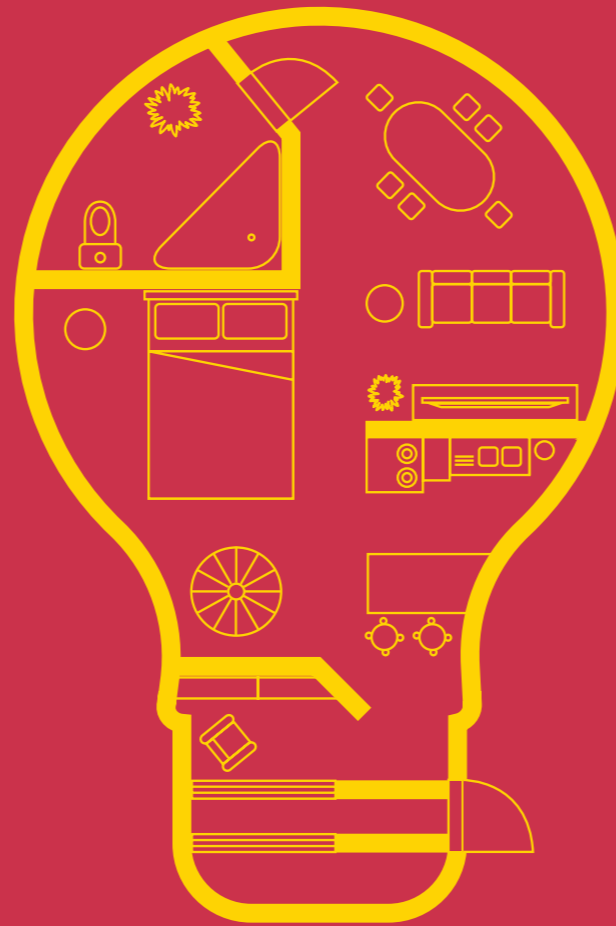

## Superior design and quality



**LARGE ROCKER**  
Ergonomically designed for a great user experience



**GLOSSY FINISH**  
Smooth glossy surface makes cleaning fuss-free.



**COMPLIANT WITH STANDARDS**  
**ELOÉ™** is designed to meet international standards – IEC and BS.



**DESIGNED TO LAST**  
Even the concealed functional parts have been carefully designed.

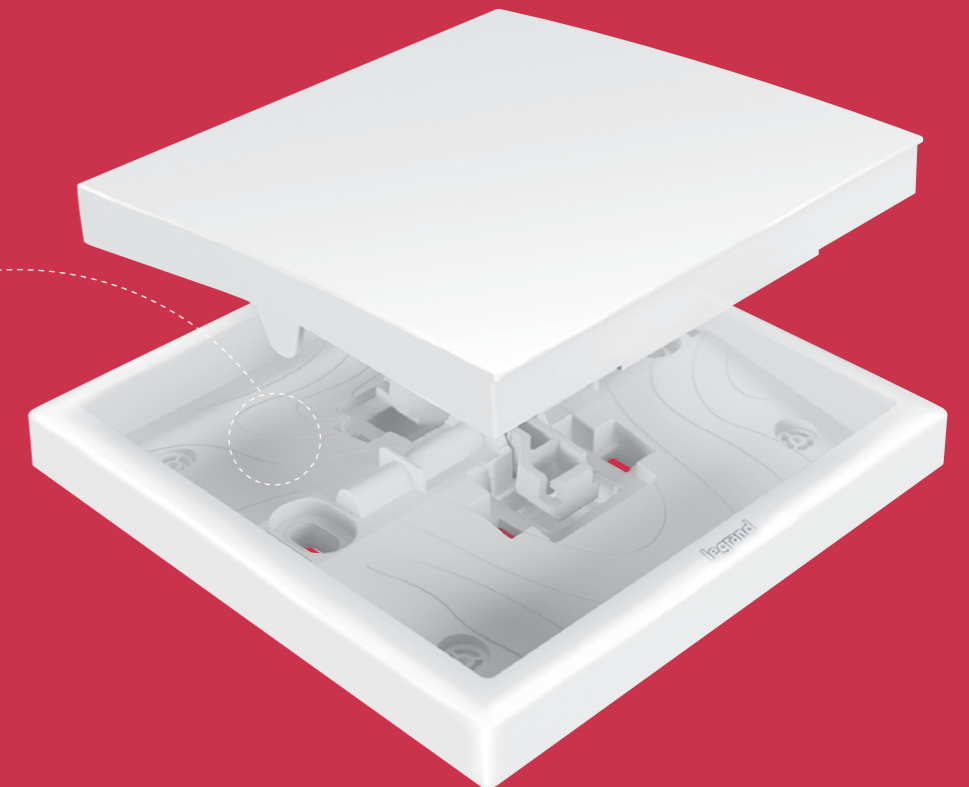

# ADD VALUE to your productivity

No matter how unpredictable the conditions at your worksite may be, **ELOÉ™** takes the uncertainty out of your project by making every installation simple, fuss-free, safe, on time – and on budget.



**EASY  
QUICK**

**TIME SAVING**  
Large terminal capacity allows for quick and easy wiring and connection to multiple outlets.



**ROBUSTNESS**  
Ribbs make the switch sturdy.

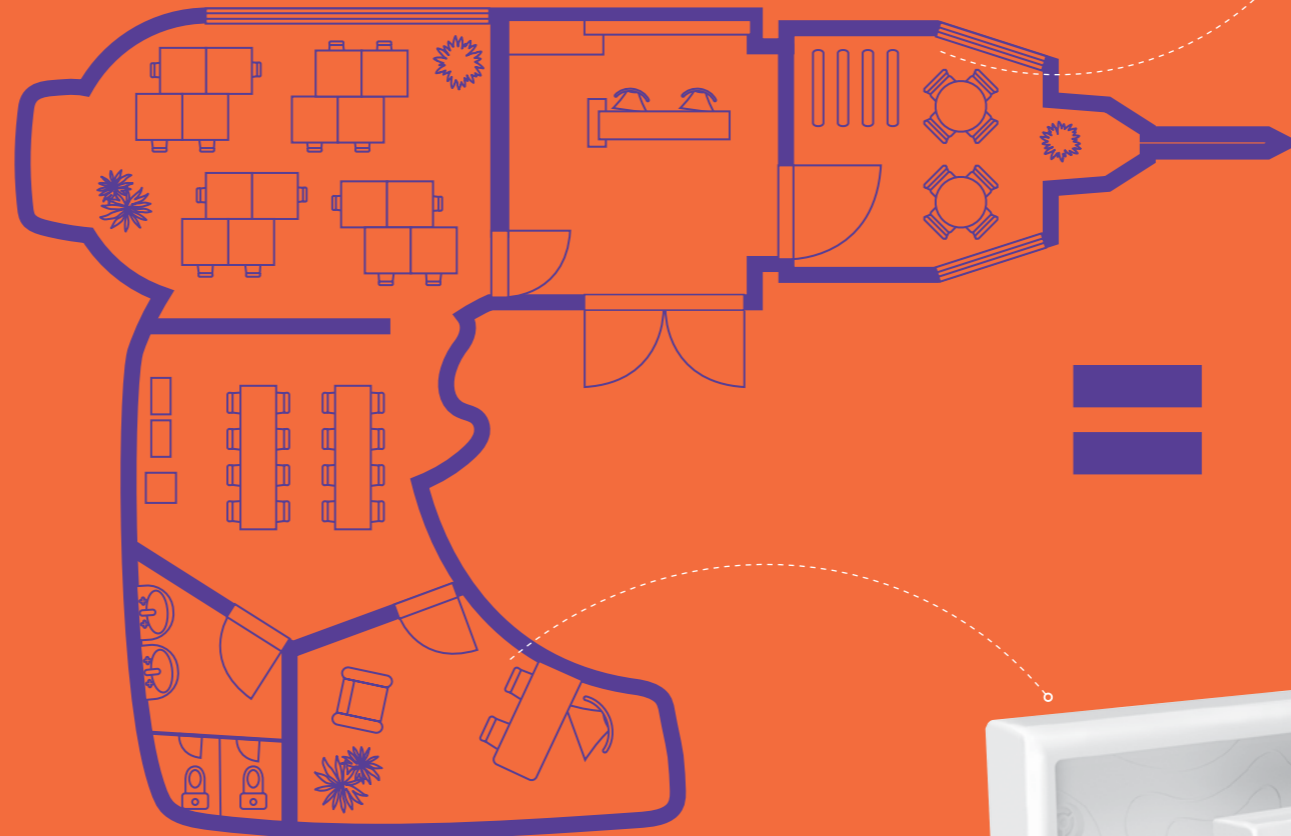

## Easy installation



**UNIVERSAL SCREW HEADS**

For both wiring and adjusting **ELOÉ™**, you need only one screwdriver head to get the installation done.

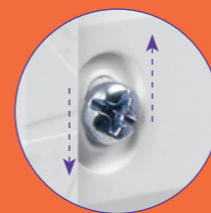

**FLEXIBILITY**  
Oblong shaped holes ensure flexibility for easy adjustment when the switch is not straight.



**EASY TO ORDER**  
1 catalogue number = 1 complete product



**SAFE AND FAST INSTALLATION**  
No access to metal parts ensures your safety during installation. The one-piece plate/mechanism also means that installation can be completed in three simple steps.

# ADD POSSIBILITIES to projects

Whether you are working on an integrated development or a straightforward build, **ELOÉ™** provides the functions you need.



The splash-proof cover allows a 1-gang **ELOÉ™** mechanism to be installed in outdoor environments. It also ensures protection against dust. With plug engaged, IP55 protection is maintained.

1-gang British standard 13A socket with USB Type-C charger and IP55 cover

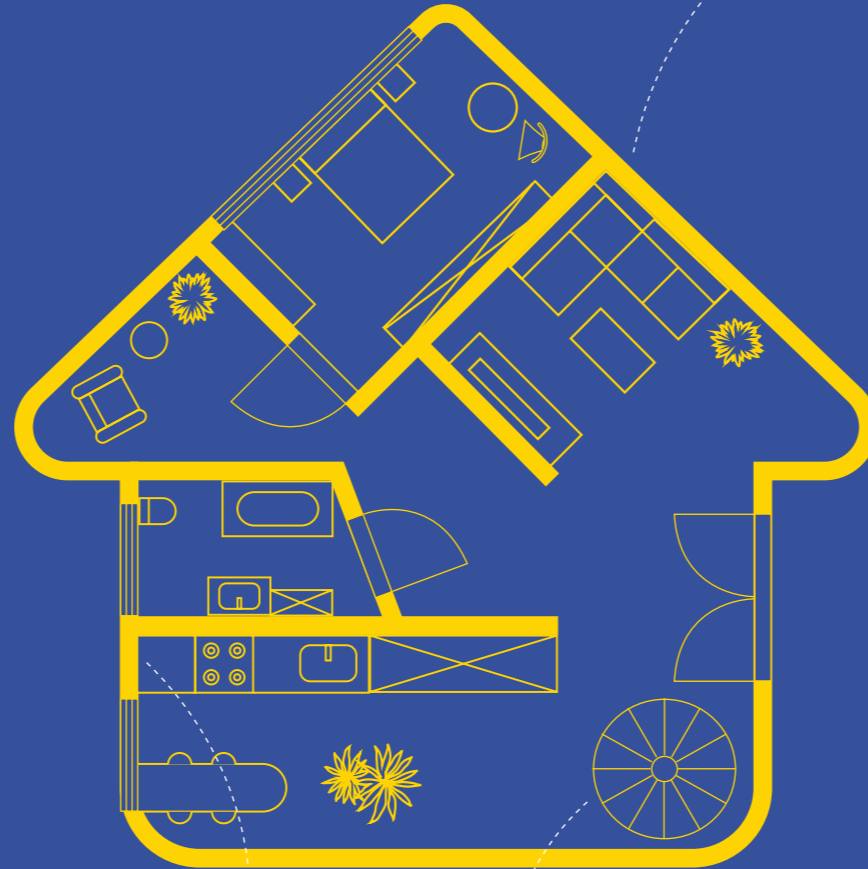

## Versatility for modern living



**UNIVERSAL DIMMER SUITABLE FOR ALL MODERN LOADS**



Dimmable LEDs



Dimmable compact fluorescent lamps



Incandescent and halogen lamps



Halogen lamps with electronic or ferromagnetic transformer

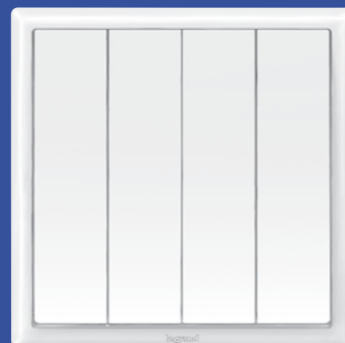

4-gang switch



1-gang British standard switched 13A socket with USB Type-A charger

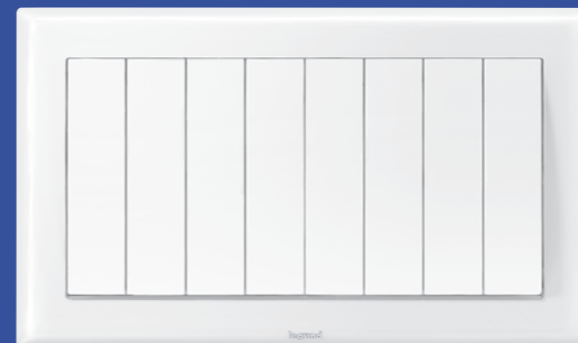

2x4-gang switch in 2-gang box

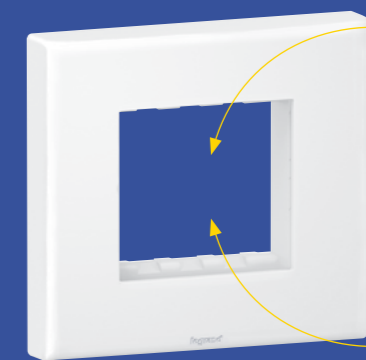

Adapter for Arteor mechanism



Electronic room thermostat



HDMI socket



There is no settling for less. **ELOÉ™** works both independently and with the Arteor range. The Arteor adapter offers versatility for your every need – residential, commercial and hospitality projects.



# ADD a touch of COMFORT

Comfort is the cornerstone of any hospitality project. That is why the **ELOÉ™** range provides dedicated hospitality functions for enhancing experiences in both guest rooms and shared spaces.



Key card switch

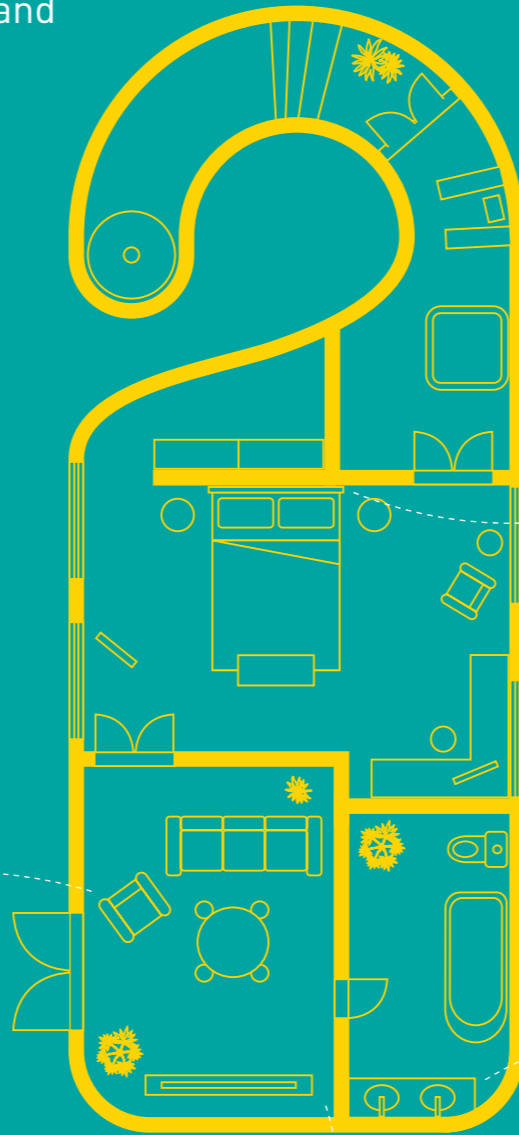

2-gang British standard switched 13A socket with USB Type-A & Type-C dual charger



With this multipurpose socket, you can leave it to **ELOÉ™** to power and charge up your devices while you recharge yourself.



## Better hospitality experiences



External indicator for corridor

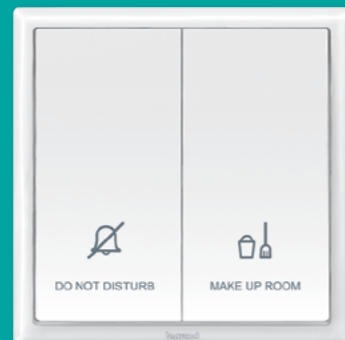

Internal control unit



Keystone data socket



1-gang Multistandard switched 13A socket with USB Type-A charger



Shaver socket

ELOÉ™

single pole switches and push-buttons



Conform to BS EN 60669-1  
 Material: Thermoplastic with glossy finish  
 Dimensions: 86 x 86 x 9.5 mm (1-gang) / 86 x 146 x 9.5 mm (2-gang)  
 Supplied with 2 screws M3.5 for BS boxes

Pack	Cat.Nos	Single pole switches 16 AX - 250 V~
10	6 180 00	1-gang 1-way switch ○ White
10	6 180 01	1-gang 2-way switch ○ White
10	6 180 02	2-gang 1-way switch ○ White
10	6 180 03	2-gang 2-way switch ○ White
10	6 180 09	Intermediate switch ○ White
10	6 180 04	3-gang 1-way switch ○ White
10	6 180 05	3-gang 2-way switch ○ White
10	6 180 06	4-gang 1-way switch ○ White
10	6 180 07	4-gang 2-way switch ○ White

Pack	Cat.Nos	Single pole switches 16 AX - 250 V~ (continued)
5	6 180 24	2x2-gang 2-way switch ○ White
5	6 180 66	2x3-gang 1-way switch ○ White
5	6 180 68	2x4-gang 1-way switch ○ White

Pack	Cat.Nos	Single pole switches 20 AX - 250 V~
10	6 180 20	1-gang 1-way switch ○ White
10	6 180 22	2-gang 1-way switch ○ White

Pack	Cat.Nos	Push-buttons 6 A - 250 V~
10	6 180 10	1-gang ○ White
10	6 180 15	2-gang ○ White
10	6 180 11	Bell push ○ White
10	6 180 16	2-gang for shutters ○ White

ELOÉ™

double pole switches and cooker control unit



Material: Thermoplastic with glossy finish  
 Dimensions: 86 x 86 x 9.5 mm (1-gang) / 86 x 146 x 9.5 mm (2-gang)  
 Supplied with 2 screws M3.5 for BS boxes





Pack	Cat.Nos	Double pole switches 20 A - 250 V~
10	6 180 70	1-gang 1-way switch + red neon indicator ○ White
10	6 180 71	1-gang 1-way switch + red neon indicator + 1 earth connection ○ White
10	6 180 71 SH	1-gang 2-way switch + red neon indicator + 2 earth connection ○ White
10	6 180 72	1-gang 1-way switch + red neon indicator + 1 earth connection with "Water Heater" marking ○ White
10	6 180 79	1-gang 2-way switch + red neon indicator + 1 earth connection with "Water Heater" marking ○ White
10	6 180 74	Double pole switches 32 A - 250 V~ 1-gang 1-way switch + red neon indicator ○ White

Pack	Cat.Nos	Double pole switches 45 A - 250 V~
10	6 180 75	1-gang 1-way switch ○ White
10	6 180 76	1-gang 1-way switch + red neon indicator ○ White
5	6 180 77	2-gang 1-way vertical switch + red neon indicator ○ White
5	6 180 78	Cooker control unit - 250 V 45 A double pole switch + red neon and 13 A BS switched socket outlet + red neon ○ White



6 180 35      6 180 96

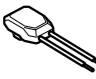
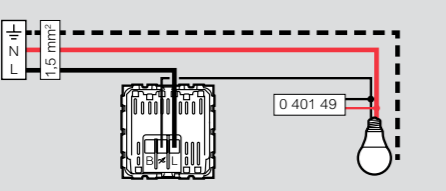





Material: Thermoplastic with glossy finish  
Dimensions: 86 x 86 x 9.5 mm (1-gang)  
Supplied with 2 screws M3.5 for BS boxes

Pack	Cat.Nos	Dimmers
1	6 180 31	<b>500 W RL dimmer</b> Push on/off and rotary dimmer - 50/60 Hz 1-gang 2-way : - 60-500W (230 V) for halogen lamps with electronic transformer with leading edge behaviour ○ White 
1	6 180 35	<b>200W LED + 300W Incandescent Rotary dimmer</b> For all types of lamps: - dimmable LEDs: 5 W to 200 W (10 lamps max. 5 W to 37 W (100 V)) - dimmable compact fluorescent lamps: 5 W to 75 W (10 lamps max. 5 W to 37 W (100 V)) - halogen with ferromagnetic or electronic transformer: 5 VA to 300 VA / 5 VA to 150 VA (100 V) - fluorescent tube - ballast: 5 VA to 300 VA / 5 VA to 150 VA (100 V) - halogen and incandescent 240 V 5 W to 300 W / 5 W to 150 W (100 V) When switched on, gradually (2 seconds) lights up at the level set before last switch-off ○ White 
1	0 401 49	<b>Active Power Compensator</b> Makes 2-wire electronic lighting control units without neutral compatible with all commercially-available loads (LED, compact fluorescent, ELV halogen with ferromagnetic or electronic ballast, 230 V halogen, fluorescent tube, incandescent) Consumption 0.4 W 
		
1	6 180 96	<b>5-speed fan control</b> Conform to BS EN 60669-2-1 <b>Fan control 240 V ~ - 50 Hz 100VA</b> ○ White 



6 180 27      6 180 26      6 180 38





Material: Thermoplastic with glossy finish  
Dimensions: 86 x 86 x 9.5 mm (1-gang)  
Supplied with 2 screws M3.5 for BS boxes

Pack	Cat.Nos	Television sockets
10	6 180 27	<b>Single TV socket, female</b> ○ White 
10	6 180 26	<b>Single TV socket, F-type</b> ○ White 
10	6 180 38	<b>Double TV socket, female + SAT, F-type</b> ○ White 
5	6 180 32	<b>TV-R-SAT socket</b> ○ White 
Pack	Cat.Nos	Telephone sockets
5	6 180 95	<b>BS master</b> ○ White 
10	6 180 97	<b>RJ 11 socket</b> ○ White 



6 180 93      6 180 91      6 180 92





Material: Thermoplastic with glossy finish  
Dimensions: 86 x 86 x 9.5 mm (1-gang)  
Supplied with 2 screws M3.5 for BS boxes

Pack	Cat.Nos	Data sockets
10	6 180 93	<b>RJ 45 Cat.5 UTP</b> ○ White 
10	6 180 91	<b>RJ 45 Cat.6 UTP</b> ○ White 
10	6 180 92	<b>Double RJ 45 Cat.6 UTP</b> ○ White 
10	6 180 17	<b>1-gang - single Keystone adaptor</b> ○ White 
10	6 180 34	<b>1-gang - double Keystone adaptor</b> ○ White 

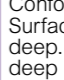

6 180 12      6 180 18      6 180 37 + 5 720 78

Material: Thermoplastic with glossy finish  
Dimensions: 86 x 86 x 9.5 mm (1-gang) / 86 x 146 x 9.5 mm (2-gang)  
Supplied with 2 screws M3.5 for BS boxes

Pack	Cat.Nos	Key card switch
1	6 180 12	16 A - 230 V ~ - 50/60 Hz Time delay of approx. 30 s after card removal Use card with width max. 54 mm ○ White 
Pack	Cat.Nos	Hotel bedroom call indicators
10	6 180 13	Enable the resident to inform hotel staff of the room status. 2 settings: - Do not disturb - Make up room ○ White 
10	6 180 14	<b>External Indicator for corridor</b> Installed in the corridor, displays calls ○ White 
10	6 180 14	<b>Internal control unit</b> Installed in the room, allows the user to select the desired setting ○ White 
Pack	Cat.Nos	Shaver sockets
1	6 180 18	Conform to BS 61558. 115/230 V - 20 VA - 50/60 Hz Surface or flush-mounting, back box to be min. 47 mm deep. Spacer delivered to fit in standard box, 35 mm deep ○ White 
Pack	Cat.Nos	Arteor adaptor
10	6 180 37	Allows the integration of 2-module Arteor mechanisms such as R.C.B.O., automatic switch, skirting light, USB charger, etc ○ White 

For integration of Arteor functions, see **Arteor offer**





ELOÉ™

socket outlets



Material: Thermoplastic with glossy finish  
 Dimensions: 86 x 86 x 9.5 mm (1-gang) / 86 x 146 x 9.5 mm (2-gang).  
 Supplied with 2 screws M3.5 for BS boxes

Pack	Cat.Nos	British Standard socket outlets 13 A - 250 V~
10	6 180 41	Conform to BS 1363-2 <b>1-gang single pole switched</b> ○ White
5	6 180 46	<b>2-gang single pole switched</b> ○ White
10	6 180 40	<b>1-gang unswitched</b> ○ White
5	6 180 45	<b>2-gang unswitched</b> ○ White
10	6 180 43	<b>1-gang double pole switched</b> ○ White
5	6 180 73	<b>1-gang double pole switched 2 earth terminal</b> ○ White
5	6 180 48	<b>2-gang double pole switched</b> ○ White
10	6 180 42	<b>1-gang single pole switched + neon</b> ○ White
5	6 180 47	<b>2-gang single pole switched + neon</b> ○ White
5	6 180 49	<b>2-gang single pole switched with red cover + neon</b> ● Red

Pack	Cat.Nos	British Standard socket outlets 13 A - 250 V~ with USB charger
1	6 180 58	Conform to BS 1363-2 Conform to IEC 60950-1 <b>1-gang single pole switched with USB Type-A</b> 3 A - 5 V <sub>DC</sub> 15 W Consumption in passive mode < 0.08 W ○ White
1	6 180 57	<b>1-gang unswitched with USB Type-A</b> 3 A - 5 V <sub>DC</sub> 15 W Consumption in passive mode < 0.08 W ○ White
1	6 180 30	<b>1-gang unswitched with USB Type-C</b> 3 A - 5 V <sub>DC</sub> 15 W Consumption in passive mode < 0.08 W ○ White
1	6 180 44	<b>2-gang single pole switched with USB Type-A + Type-C</b> 3 A - 5 V <sub>DC</sub> 15 W Consumption in passive mode < 0.08 W ○ White
10	6 180 51	Conform to BS 546 <b>1-gang single pole switched</b> ○ White
5	6 180 52	<b>1-gang single pole switched + neon</b> ○ White
5	6 180 53	<b>2-gang single pole switched</b> ○ White
10	6 180 54	Conform to BS 546 <b>1-gang single pole switched</b> ○ White

ELOÉ™

socket outlets (continued)



Material: Thermoplastic with glossy finish  
 Dimensions: 86 x 86 x 9.5 mm (1-gang) / 86 x 146 x 9.5 mm (2-gang)  
 Supplied with 2 screws M3.5 for BS boxes

Pack	Cat.Nos	Euro/US socket outlets - 16 A - 250 V~ / 15 A - 127 V~
10	6 180 62	<b>1-gang 2 x 2P</b> ○ White
10	6 180 90	<b>1-gang 2 x 2P switched</b> ○ White
10	6 180 64	<b>1-gang 2 x 2P+E</b> ○ White
10	6 180 56	<b>German Standard socket outlet 16 A - 250 V~</b> <b>1-gang 2P+E with shutters for child protection</b> ○ White
10	6 180 67	<b>Multistandard switched socket outlet 15 A 127 V~ / 16 A 250 V~</b> <b>1-gang</b> ○ White
5	6 180 69	<b>2-gang</b> ○ White

Pack	Cat.Nos	Multistandard switched socket and Euro/ US socket outlets
10	6 180 65	<b>1-gang</b> ○ White
1	6 180 59	<b>Multistandard switched socket outlets 16 A 250 V~ / 15 A - 127 V~ with USB charger</b> Shuttered for child safety USB charger conform to IEC 60950-1 <b>1-gang 2P+E with USB Type-A</b> 3 A - 5 V <sub>DC</sub> 15 W Consumption in passive mode < 0.08 W ○ White
1	6 180 55	<b>2-gang 2 x 2P+E with USB Type-A + Type-C</b> 3 A - 5 V <sub>DC</sub> 15 W Consumption in passive mode < 0.08 W ○ White



6 180 82

6 180 85

Material: Thermoplastic with glossy finish  
 Dimensions: 86 x 86 x 9.5 mm (1-gang) / 86 x 146 x 9.5 mm (2-gang)  
 Supplied with 2 screws M3.5 for BS boxes

**Fused connection units 13 A**

Pack	Cat.Nos	Description
10	6 180 80	Conform to BS 1363-4 <b>Unswitched + cord outlet</b> ○ White
5	6 180 81	<b>Switched + cord outlet</b> ○ White
10	6 180 60	<b>Unswitched + neon + cord outlet</b> ○ White
10	6 180 82	<b>Switched + neon + cord outlet</b> ○ White

**Cable outlets**  
 Conform to BS 5733

10	6 180 85	<b>20 A - 250 V~</b> ○ White
10	6 180 86	<b>45 A - 250 V~</b> ○ White



6 180 28

6 180 37 + 5 720 72

6 176 36 + 6 180 30

**Blanking plates**

Pack	Cat.Nos	Description
10	6 180 28	Conform to IEC 60670-1 <b>1-gang</b> ○ White
10	6 180 39	<b>2-gang</b> ○ White

**Arteur adaptor**  
 Allows the integration of 2-module Arteur mechanisms such as R.C.B.O., automatic switch, skirting light, USB charger, etc

10	6 180 37	<b>1-gang</b> ○ White
----	----------	--------------------------

**Fixing accessories**  
**Splash-proof cover**  
 Mainly for socket protection IP 55 with or without plug engaged  
 Space inside : 86 x 86 mm  
 External dimensions : 129,2 x 107,2 x 54,1 mm

4	6 176 36	● Mist grey
---	----------	-------------

**Surface-mounting boxes**

Pack	Cat.Nos	Description
8	6 133 50	Conform to BS 5733 Depth 35 mm <b>1-gang</b> ○ White
4	6 133 51	<b>2-gang</b> ○ White

For integration of Arteur functions, see **Arteur offer**





### Head Office

and International Department  
87045 Limoges Cedex - France

 + 33 (0) 5 55 06 87 87

 + 33 (0) 5 55 06 74 55

### FOLLOW US ON:

 [legrand.com](https://www.legrand.com)

 [youtube.com/user/legrand](https://www.youtube.com/user/legrand)

 [twitter.com/Legrand](https://twitter.com/Legrand)

 [pinterest.com/legrandgroup](https://www.pinterest.com/legrandgroup)

 [facebook.com/Legrand](https://www.facebook.com/Legrand)

 [instagram.com/legrandnews](https://www.instagram.com/legrandnews)